

# TECHNICAL DATA SHEET

## Cap size: 82mm Twist Cap (KA-82-S1 / S-1541)

**Description:** Twist cap with no flip panel, made for sealing glass jars containing food or juice.

### DIMENSIONS

**Glass Finish:** GPI 2040

|                                |              |
|--------------------------------|--------------|
| <b>D (Outside Dia.)</b>        | 3.345/3.360" |
| <b>E (Plug Dia.)</b>           | 3.073/3.088" |
| <b>H (Overall Height)</b>      | .410/.430"   |
| <b>C (Compound Thickness)</b>  | .022/.047"   |
| <b>S (Dist. To top of Lug)</b> | .360/.380"   |

### Materials

**Electrolytic tin plate or Tin free steel**

- Minimum Nominal Thickness: .0066"

### Interior Coating

- Food grade interior coating system specified according to product requirement. (FDA compliant)

### Exterior Coating

- White, clear or gold base coat with over varnish as required
- Printing decoration according to customer specification.

### Compound

- Food grade plastisol according to thermal process (pasteurization, hot fill and cool, dry seal, retort) and product type (oily and non-oily). (FDA compliant)

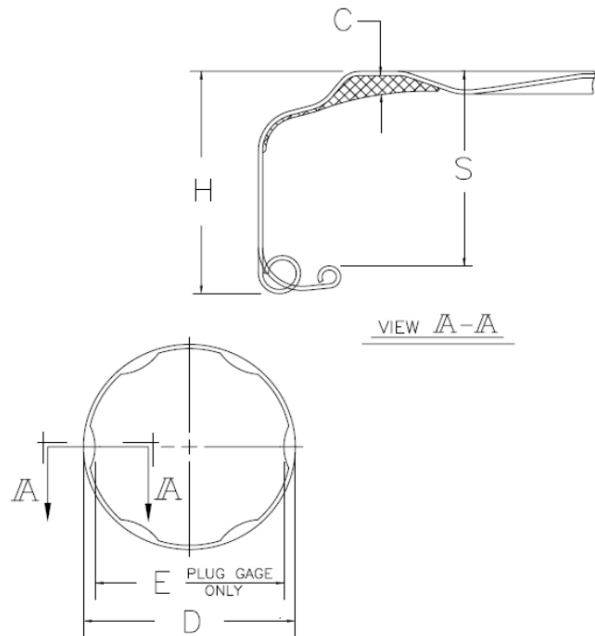

|                          | Yes | No | NOTES:                     |
|--------------------------|-----|----|----------------------------|
| <b>Pasteurization***</b> | x   |    | 1) Can also be cold-filled |
| <b>Hot Fill***</b>       | x   |    | 2)                         |
| <b>Retort***</b>         |     | x  | 3)                         |

\*\*\*Note: Mfr will recommend the compound and coating system but the consumer must make the final decision.

### PACKAGING

| Carton       |                | Pallet             |         |
|--------------|----------------|--------------------|---------|
| Size (in)    | 20 x 11.5 x 16 | Size (in)          | 40 x 48 |
| Caps Qty.    | 750            | Cartons per pallet | 40      |
| Gross Weight | 24.0 lbs.      | Caps per pallet    | 30000   |

**Note:** Quantity of closures in cartons may vary dependent upon manufacturing plant.

**Stacking:** Cap cartons should not be stacked more than 2 pallets high

**Storage conditions:** Temperature range from 40 - 86°F (5 - 30°C) - relative humidity below 70%.

Closures should be used within 2 years of the manufacturing date on the carton (Deviation granted under Crown's approval).

DISTRIBUTED BY:



REF NO.:

DWG31584

### DISCLAIMER

THIS INFORMATION IS PROVIDED AS A GENERAL GUIDE, INCLUDING DIMENSIONS. IT IS THE CUSTOMER'S RESPONSIBILITIES TO SELECT THE PROPER CONTAINER FOR PRODUCT AND APPLICATION COMPATIBILITY.

DESCRIPTION:

82 mm Black Metal Plastisol Lined Twist-Off Cap, No Button