

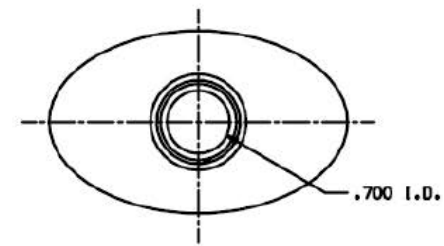

NOTES :

- 1) OVERFLOW CAPACITY : 16.85 ± .37 FL.OZ.
(486.3 ± 11.0 CC'S.)
- 2) WEIGHT : 36.0 ± 2.0 GRAMS

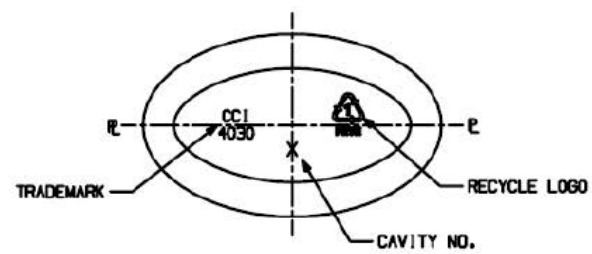

| | | |
|--|--|-----------------|
| <p>DISCLAIMER</p> <p>THIS INFORMATION IS PROVIDED AS A GENERAL GUIDE, INCLUDING DIMENSIONS. IT IS THE CUSTOMER'S RESPONSIBILITIES TO SELECT THE PROPER CONTAINER FOR PRODUCT AND APPLICATION COMPATIBILITY.</p> | <p>DISTRIBUTED BY:</p>  | <p>REF NO.:</p> |
| | <p>DESCRIPTION:</p> | |