

OPTIONAL construction:
Bead NOT required for
child resistant closure
function

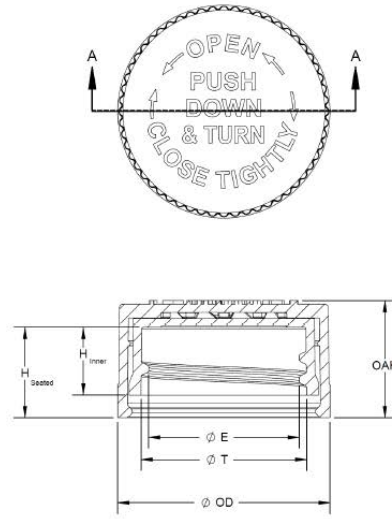

SECTION A-A
SCALE 1:1
SCALE 2:1

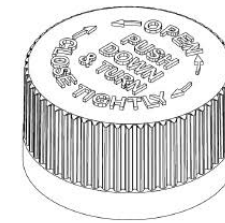

DETAIL RIB
SCALE 10:1
(56) EQUISPACED RIBS



SCALE 2:1

8 THREADS PER INCH, .125 PITCH,
380° FULL DEPTH THREAD

REFERENCE	TOLERANCE	DIMENSION	UNITS
E	± 0.010 [0.25]	0.865 [21.97]	in [mm]
T	± 0.010 [0.25]	0.950 [24.13]	in [mm]
H (Seated)	REFERENCE	0.517 [13.13]	in [mm]
H (Inner)	± 0.007 [0.18]	0.388 [9.86]	in [mm]
OAH	± 0.015 [0.38]	0.668 [16.97]	in [mm]
OD	± 0.015 [0.38]	1.217 [30.91]	in [mm]
PART WEIGHT	± 0.60	4.10	g

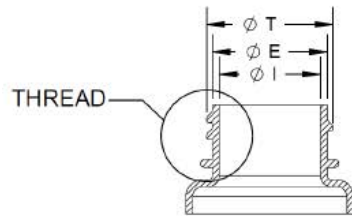
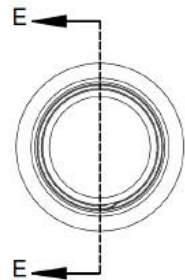

SECTION E-E

[1.27mm]
.050 MINIMUM FLAT
RECOMMENDED FOR
PROPER INDUCTION SEAL

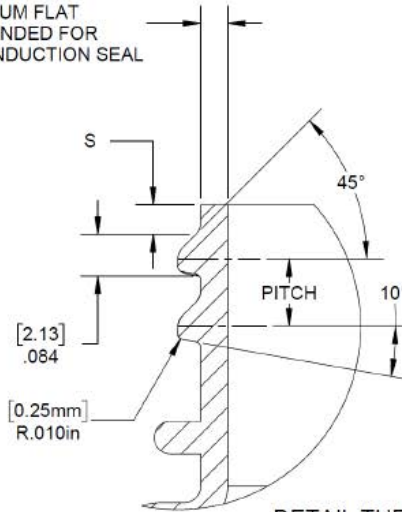

DETAIL THREAD
SCALE 4:1

REFERENCE	TOLERANCE	UNITS	DIMENSION
E	± 0.008 [0.20]	in [mm]	0.848 [21.54]
T	± 0.008 [0.20]	in [mm]	0.932 [23.67]
I	MINIMUM	in [mm]	0.516 [13.11]
S	± 0.015 [0.38]	in [mm]	0.046 [1.17]
H	MINIMUM	in [mm]	0.400 [10.16]
H1	MINIMUM	in [mm]	0.550 [13.97]
ϕ BEAD	MAXIMUM	in [mm]	1.020 [25.91]
TPI		in	8
PITCH		in [mm]	0.125 [3.16]

DISCLAIMER

THIS INFORMATION IS PROVIDED AS A GENERAL GUIDE, INCLUDING DIMENSIONS. IT IS THE CUSTOMER'S RESPONSIBILITIES TO SELECT THE PROPER CONTAINER FOR PRODUCT AND APPLICATION COMPATIBILITY.

DISTRIBUTED BY:



REF NO.:

DESCRIPTION: