

Specification Data for 65x198mm(211x713) Straight Can 2P

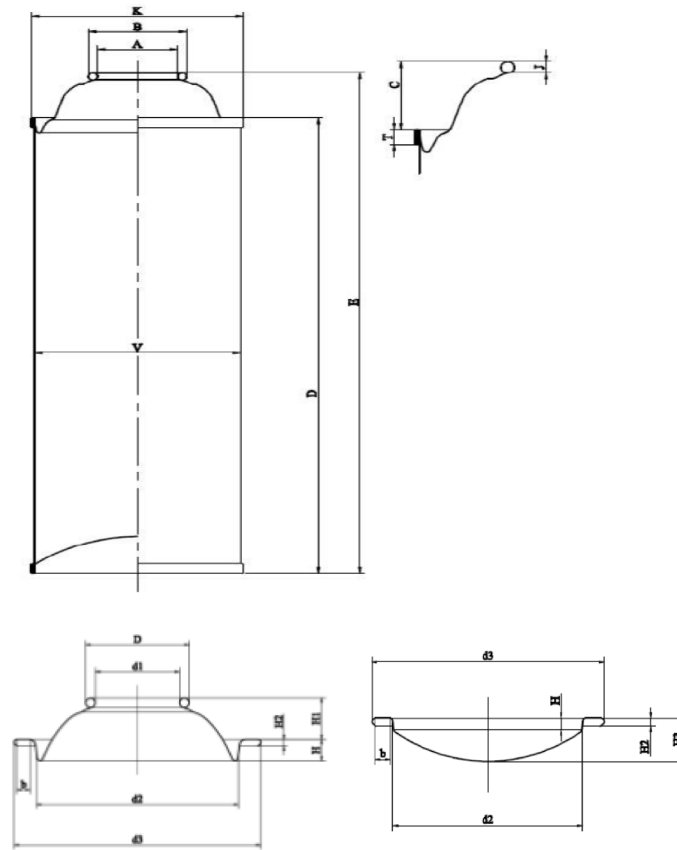

NO.	Decription	Size (mm)
A	I/S CUP OPENING	25.40 ± 0.10
B	O/S CUP OPENING	31.01 ± 0.25
C	TOP OF CURL TO THE TOP OF THE TOP DOUBLE SEAM	20.27 ± 0.30
G	CURL THICKNESS	3.30 ± 0.18
K	TOP DOUBLE SEAM OUTSIDE DIAMETER	68.58± 0.25
T	WIDTH OR HEIGHT OF TOP DOUBLE SEAM	3.31 ± 0.20
V	BODY OUTSIDE DIAMETER	65.65 ± 0.25
D	TOP OF THE TOP DOUBLE SEAM TO THE BOTTOM OF THE BOTTOM DOULBE SEAM	198±0.80
E	OVERALL HEIGHT	218.27±1.0

Thickness of tinplate (mm)			Deformer (MPA)	Bursting (MPA)	CERTIFICATE	Open size-Printable Area (mm)		
can body	cone (top)	dome (bottom)				DOT 2P	X	Y
0.2	0.35	0.4	≥ 1.25	≥ 1.66				

*Method of measurement for (dimension K, V and W) to be agreed upon between the supplier and the user if needed.

*Not all suppliers manufacture cans with D and E dimensions in the indicated sizes to conform to the Sales Code height formula. Buyer should work with their supplier(s) to determine suitable D and E dimensions for their operations.

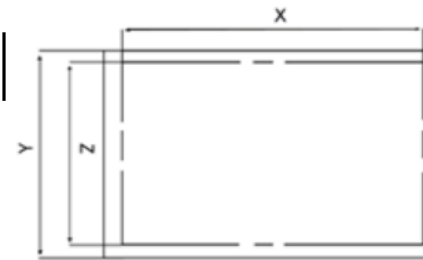

DISCLAIMER

THIS INFORMATION IS PROVIDED AS A GENERAL GUIDE, INCLUDING DIMENSIONS. IT IS THE CUSTOMER'S RESPONSIBILITIES TO SELECT THE PROPER CONTAINER FOR PRODUCT AND APPLICATION COMPATIBILITY.

DISTRIBUTED BY:



REF NO.:

DWG30048

DESCRIPTION:

22 oz Aerosol, 211 x 713, SS, 2P