

- Ⓐ 38mm CUSTOM REXAM NECK FINISH
- 1) 6 THREADS PER INCH
 - 2) PITCH .167
 - 3) 1.5 TURNS (540°) OF THREAD @ FULL DEPTH
 - 4) THREAD START IS 45° TO P.L. IN PIN HALF AS SHOWN.
 - 5) HELIX ANGLE 29°
 - 6) USE THREAD CUTTER #MA1006-89

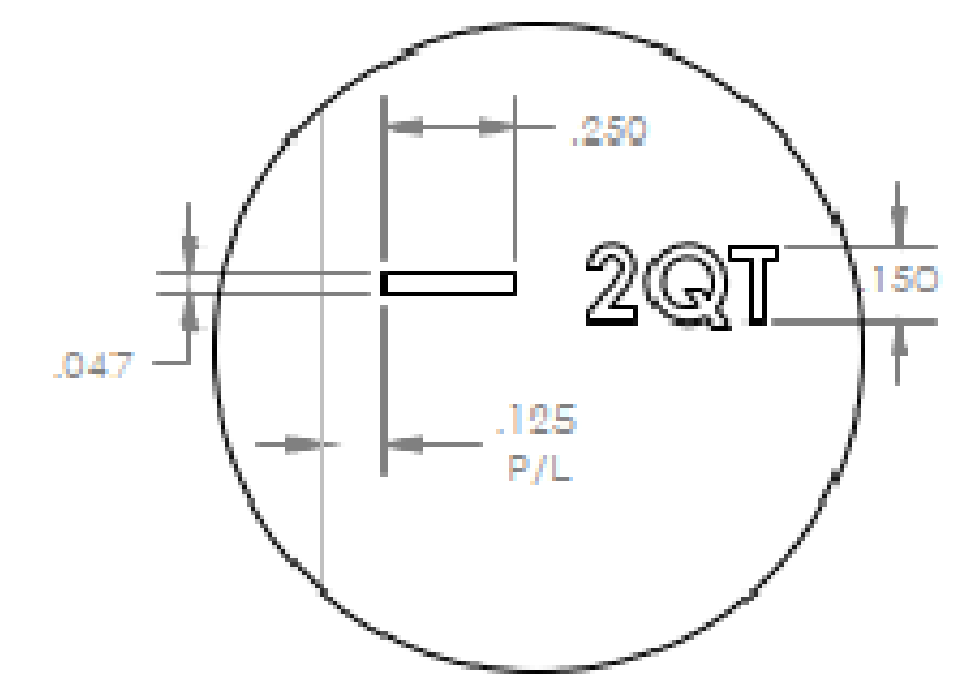
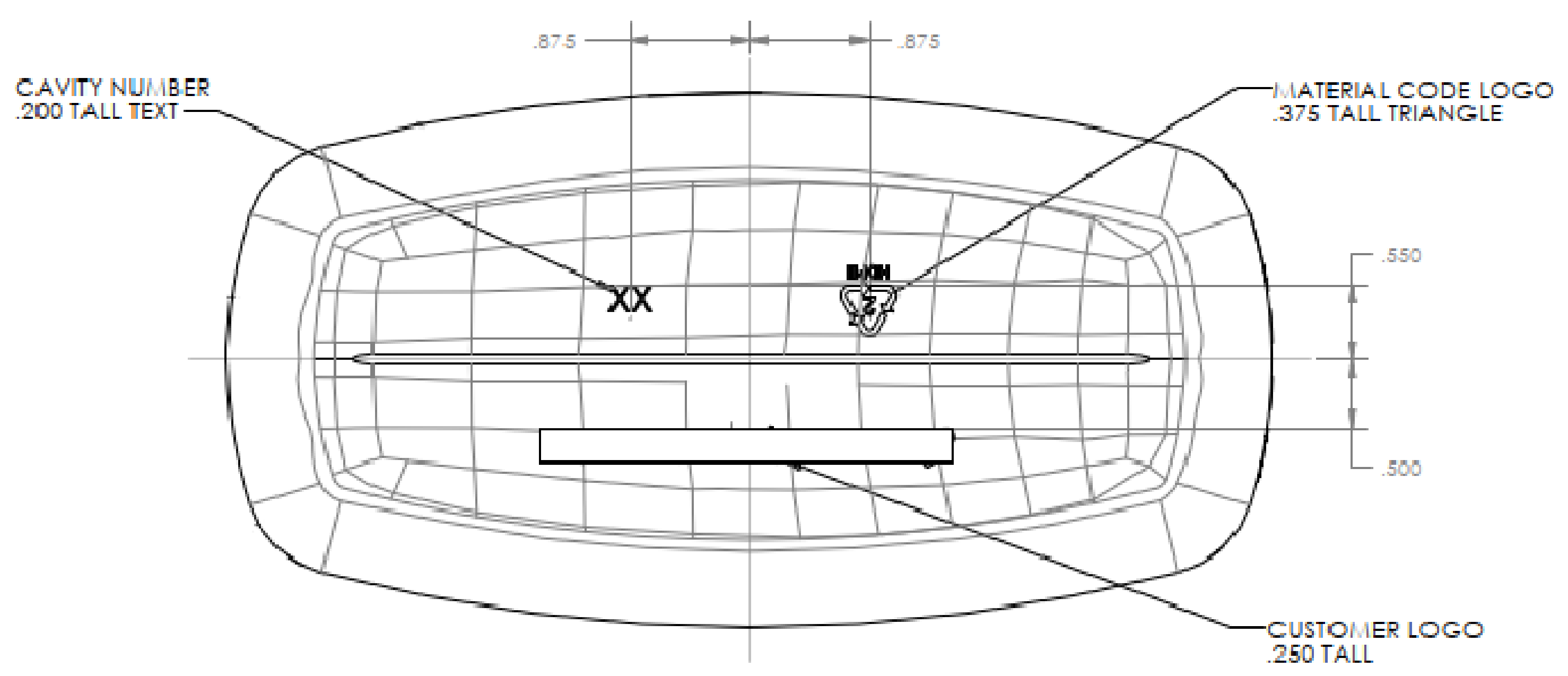

USE BALL ENDMILL FOR MARKS AND TEXT
DETAIL A
SCALE 2:1

- Notes:**
- 1) Tolerances Unless Specified:
Vertical -- .080"
Horizontal -- .090"
Volumetric -- 1.8 oz
 - 2) Bottles to be Checked Aged with 20C water
 - 3) Estimated Bulge -- 3.7 oz

Container Data:	
Weight	145 +/-3 grams
Fill Level Capacity	128 oz
Overflow Capacity	140.9 oz
Material	HDPE w/ 25% PCR

ALL ENGRAVING RAISED .010-.012

DISCLAIMER

THIS INFORMATION IS PROVIDED AS A GENERAL GUIDE, INCLUDING DIMENSIONS. IT IS THE CUSTOMER'S RESPONSIBILITIES TO SELECT THE PROPER CONTAINER FOR PRODUCT AND APPLICATION COMPATIBILITY.

DISTRIBUTED BY: Pipeline Packaging

REF NO.: DWG30977

DESCRIPTION:
128 oz White HDPE F-Style Rect Bottle, 38-400, 140 Gram, 25% PCR